

# Agenda Item 5.1

You are permitted to use this data solely to enable you to respond to, or interact with, the organisation that provided you with the data. You are not permitted to copy, sub-licence, distribute or sell any of the data to third parties in any form.

© Crown copyright and database rights 2019  
OS Licence number 100025370



This page is intentionally left blank

**LINCOLNSHIRE COUNTY COUNCIL**

**PLANNING AND REGULATION COMMITTEE UPDATE – 4 JULY 2022**

- **Attached county map showing location of applications**

**ITEMS**

**5.1 (S22/0757) & 5.2 (S22/0758) - Ministry of Defence** response received 27 June 2022 - have no safeguarding objections to these proposals.

This page is intentionally left blank

# 5.1 West Deeping

LINCOLNSHIRE COUNTY COUNCIL  
 PLANNING AND REGULATION COMMITTEE 4 JULY 2022

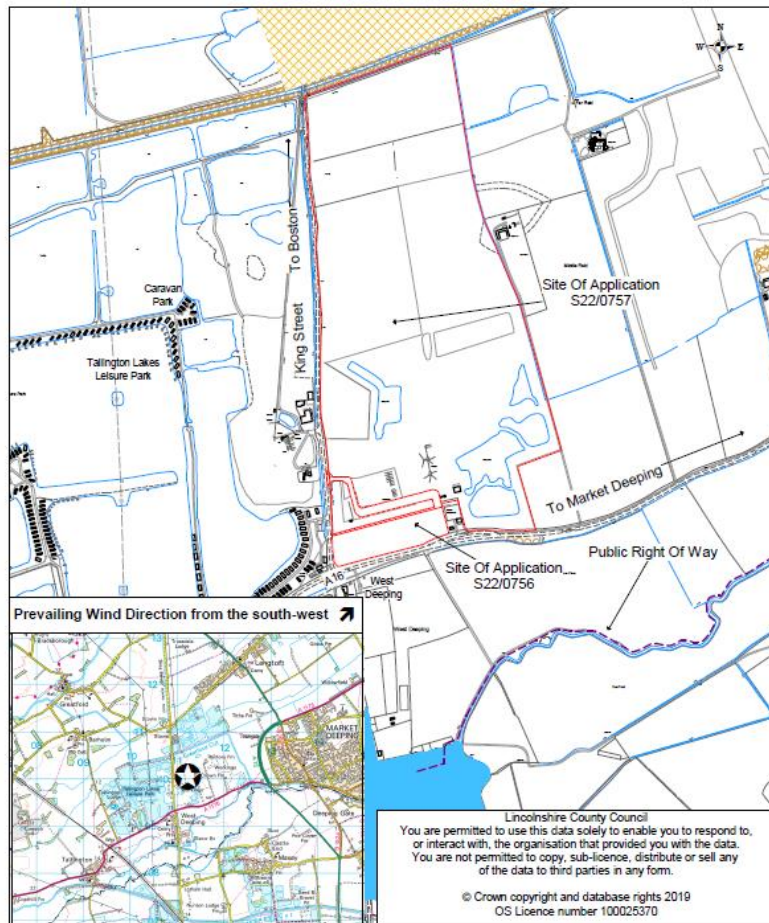

Lincolnshire County Council  
 You are permitted to use this data solely to enable you to respond to, or interact with, the organisation that provided you with the data. You are not permitted to copy, sub-licence, distribute or sell any of the data to third parties in any form.

© Crown copyright and database rights 2019  
 OS Licence number 100025370

**Location:**  
 West Deeping Quarry  
 King Street  
 West Deeping

**Application Nos:** S22/0756 & S22/0757  
**Scale:** 1:10000

**Description:**

For the proposed southern extension to existing sand and gravel extraction operations with restoration to low level agriculture and amenity/nature conservation

To vary conditions 2 and 4 of planning permission S19/2127

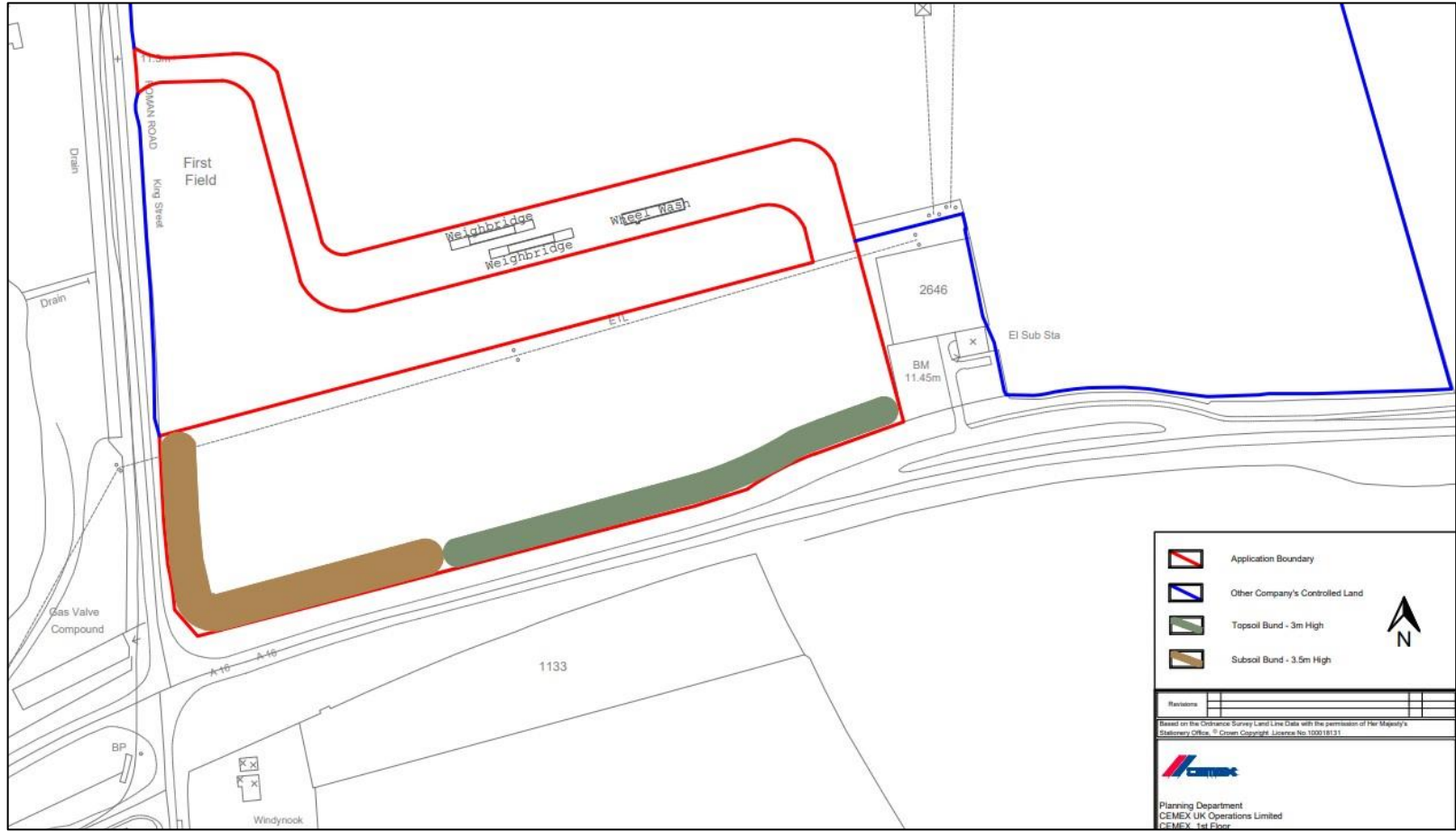



Programme of Remediation  
The extent of a Remediation Measure must be  
Plan to identify any areas of contamination to be treated  
and suitable for the 1000 parties.  
Maintenance  
All planting to be maintained by use of phosphate to cover  
Crops 1 year. This will prevent water accumulation at

Programme of Remediation  
To be carried out in November/December planting will  
Plan to identify any areas of contamination to be  
treated and suitable for the 1000 parties.  
Maintenance  
All planting to be maintained by use of phosphate  
Crops 1 year. This will prevent water accumulation  
at the base of each tree after which trees to be removed

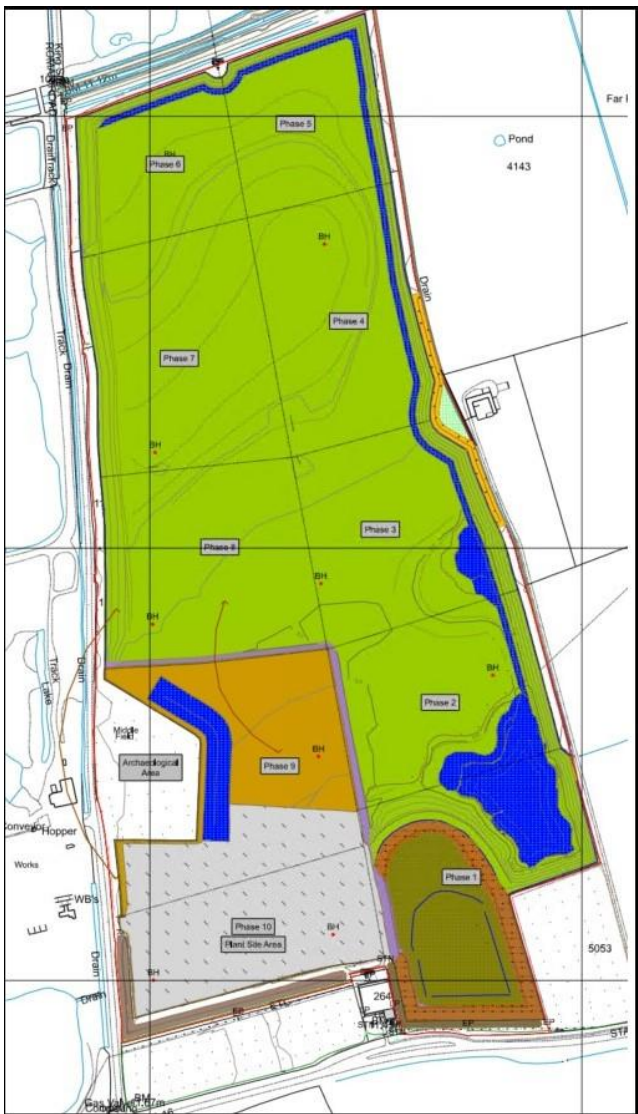





29/06/2022



## 5.2 Baston

LINCOLNSHIRE COUNTY COUNCIL  
PLANNING AND REGULATION COMMITTEE 4 JULY 2022

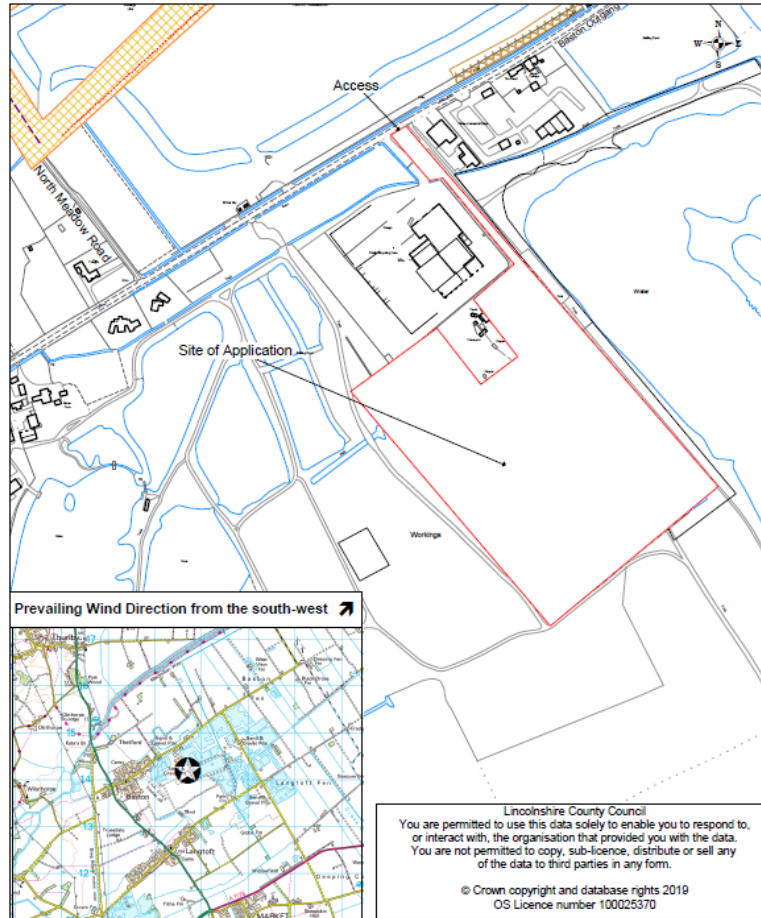

**Location:**  
Manor Pit  
Baston Outgang Road  
Baston  
**Application No:** S22/0758  
**Scale:** 1:5000

**Description:**  
For the extraction of sand and gravel beneath former plant site with enhanced restoration to amenity/nature conservation

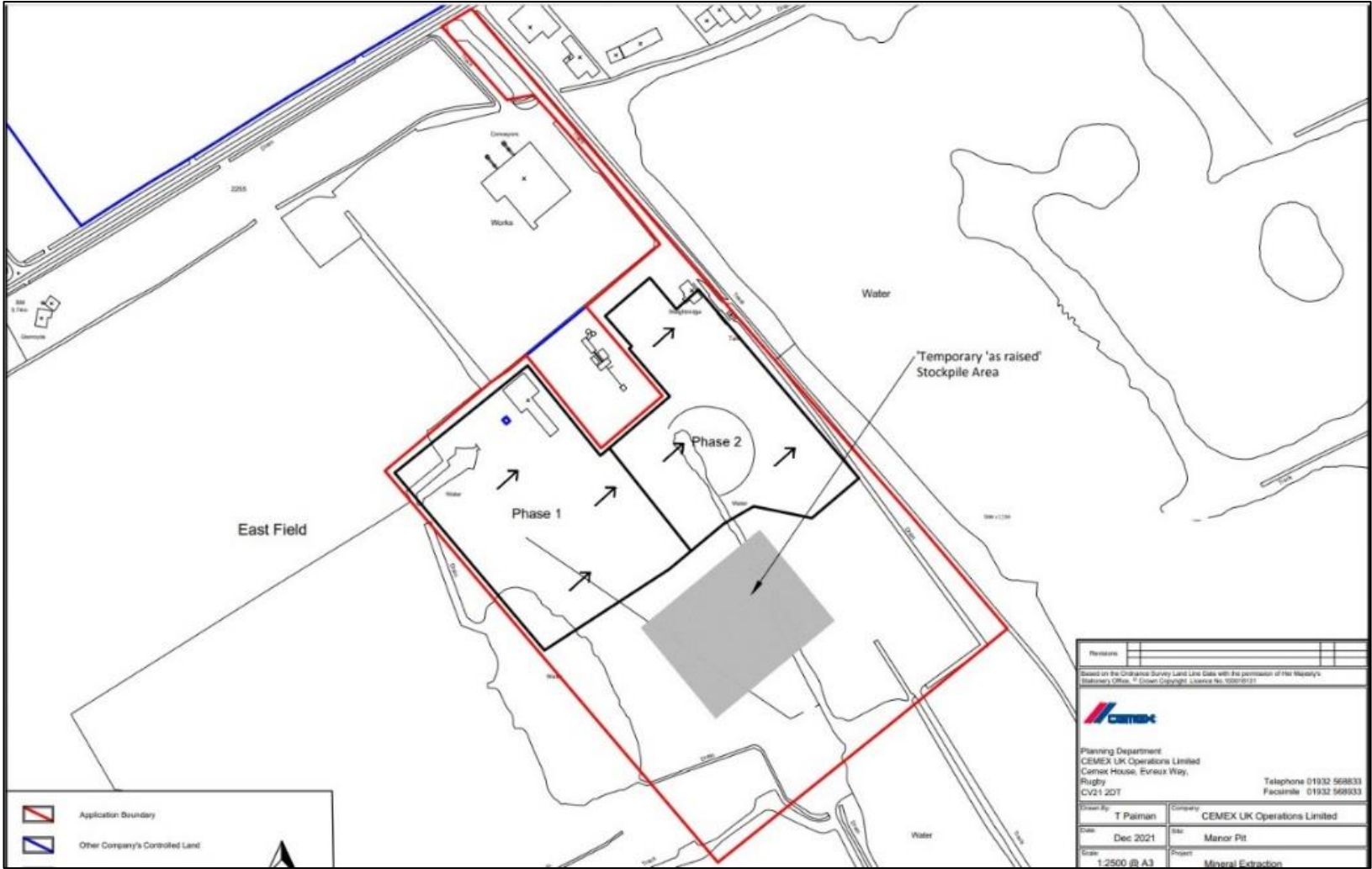

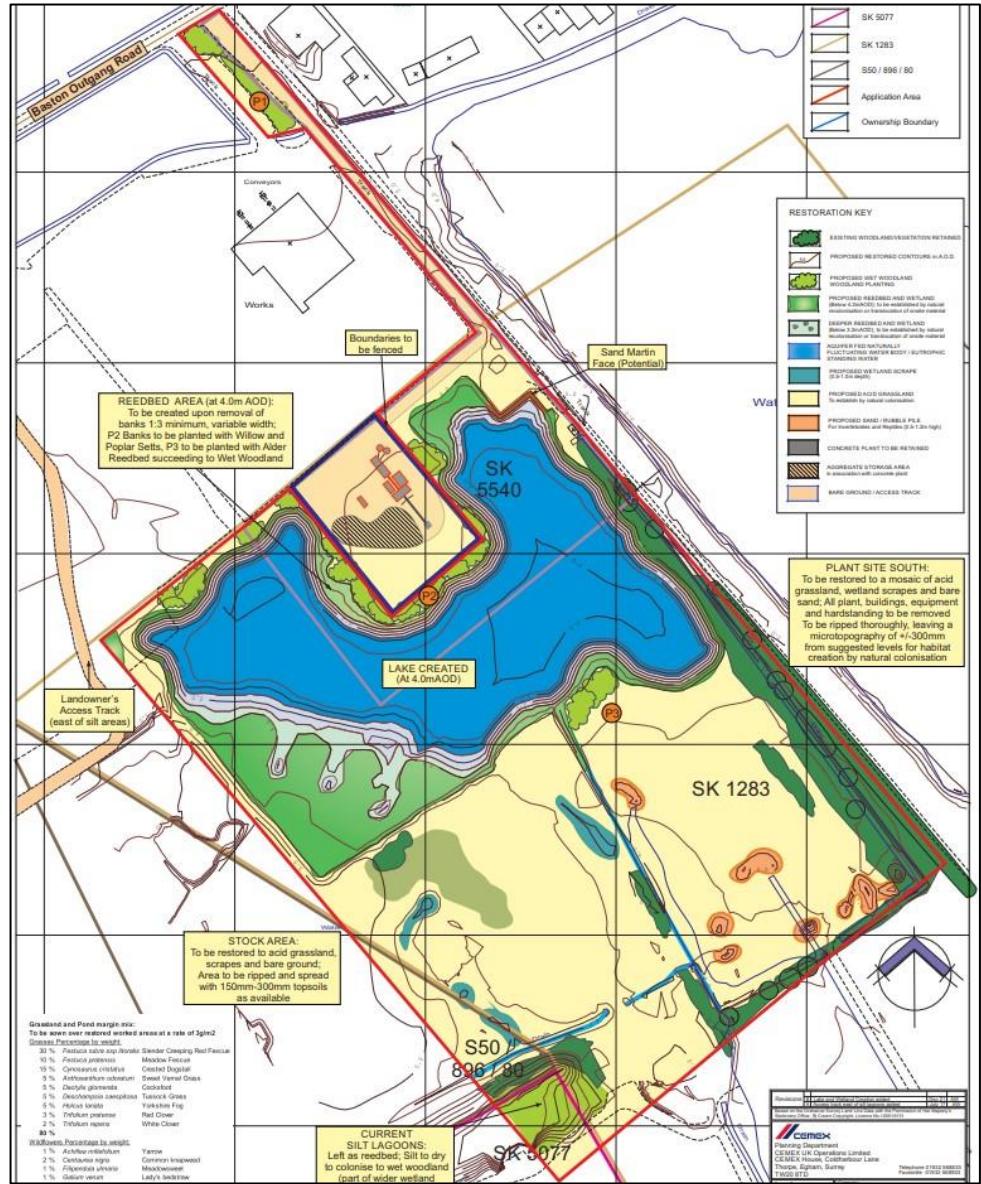





# 5.3 West Deeping

